

# Floor springs

DC477

## Floor springs

### Application:

ASSA ABLOY branded Floor Spring with closing force EN2-4 meaning suitable for use on doors with a maximum weight of 80kg and 1100mm wide. Non Hold Open variants are ideal for use on fire doors (when adjusted to give a size 3 closing force) while the Hold Open units are suitable for non fire doors. While the units can be ordered complete with a stainless steel cover, all other accessories such as spindles are sold separately.

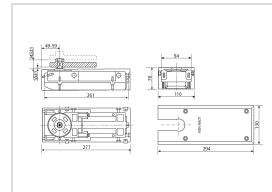

### Variants:

Code	Description
DC477A	DC477A floor spring EN2-4 hold open 105deg c/w st steel cover
DC477A/NHO	DC477A/NHO floor spring EN2-4 non hold open c/w st steel cover
DC477	DC477 floor spring mech only hold open 105deg
DC477/NHO	DC477 floor spring mech only non hold open